

8" Architectural LED Downlight

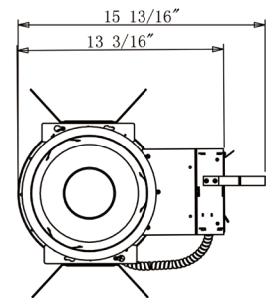
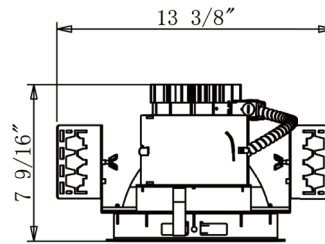

ORDER MATRIX | Example: AL8-VA1

A	B	C	D	E	F	G
A	Series					
AL8-VA1	8" Architectural Downlight LED					
B	Input Voltage					
	120V					
277	277V					
U	120-277V					
C	LED Available					
Cree	Cree					
Citizen	Citizen					
Epistar	Epistar					
Seoul	Seoul					
Osram	Osram					
D	Dimmable					
	Non-Dimmable					
DM	Dimmable					
E	Wattage					
L25	25W					
L37	37W					
L50	50W					
F	Color Temperature					
30K	3000K					
40K	4000K					
50K	5000K					
G	Options					
EM	Emergency Backup					
C	C-Channel Bar Hanger					
F	Flat Bar Hanger					
H	Wood Joist Bar Hanger					

Reflector Matrix

A	B	C
A	Trim	
SF	Self Flanged	
SFW	Self Flanged White NO Flange	
C	Lens Type	
CR	Clear Tempered	
SB	Sand Blasted	
B	Reflector Finish	
C	Clear	
HZ	Haze	
WH	White	

Description

- Lighting is smooth and comfortable while using 50% less energy than the common CFL downlight.
- Eco-friendly no lead or mercury
- Designed to install into an existing downlights mounting frame and convert them into energy efficient LED downlights to save anywhere from 35% up to 75% on energy cost.
- Ideal suited for use in commercial, retail and other architectural applications
- Available with dedicated Emergency Battery Back-up

Reflector

- High quality reflector with 1.2mm thickness
- Optional painted white flange is available

Reflector Assembly

- Reflector easily wires to dedicated frame with locking quick connect

LED Module

- Cree true white® technology available
- CRI>80%
- Color temperature: 3000K-5000K
- Rated for 50000 hours at 70% lumen output
- No heat, mercury or UV

Electrical System

- Thermal protection guard protects the LED module from overheating and will dim LED module if necessary
- PF>0.9
- Fully dimmable down to 10% of initial light output with a 0-10 Volt dimmer

Input Power	Lumens
25W (+/- 5%)	2000LM
37W (+/- 5%)	3000LM
50W(+/- 5%)	4000LM

Listing

- ETL listed for damp location W/Feed through

Frame

- Constructed from 16-gauge steel, die-formed construction for max heat dissipation and rust protection.

Clearance

- Frames require a minimum clearance of 3" ring from thermal insulation and 1/2" from adjacent building component.

Mounting

- Designed to install into an existing downlights mounting frame and convert them into energy efficient LED downlights.
- Flex is designed to attach into existing junction box.
- Vertically adjustable universal mounting brackets accept flat bar hangers, conduit or C-channel
- The reflector assembly is held in with 4 "butter-fly" spring clips.
- Reflector assy quickly attaches with lockable quick connect. Hanger bars ordered separately.
- Compatible with C-channel, flat bar wood joist bar hanger and EMT

Junction Box

- Plaster frame integrated 29 cubic inch 0.064" thick galvanized steel
- Provided with four 1/2" knockouts, one 3/4" knockout and four Romex knockouts with true pryout slots and strain clamps.
- Designed for straight through conduit runs.
- Electrical connections are made through a single junction box door.
- Green wire provided for installation with ground wire fed through PVC pipe conduit.

Thermal Protector

- External thermal device is located on the junction box wrap.

Driver

- The LED driver is mounted to the J-box cover and is accessible from below the ceiling.
- Rated for 50Hz to 60Hz at 120V/277V input
- Produces less than 20% THD